



ASPIRE

— TO MOVE —



Malvern Buildings, Bath, BA1

Malvern Buildings is a popular no through road in an elevated position in Fairfield Park.

Larkhall has a thriving village community and offers an excellent array of local amenities which include a good state primary and senior school, a doctors, dental practice and chemist, an award-winning deli, a fabulous hardware store, a greengrocer, a butchers and 2 public houses. Malvern buildings is approx 1.8 miles walk to the city centre.

- Two bedrooms
- Front and back garden
- Available August 2025
- Allocated parking space
- Ciouncil tax band C
- Holding deposit - one weeks worth of rent - £403.00
- Pets considered

£1,750 PCM

Floor Plans

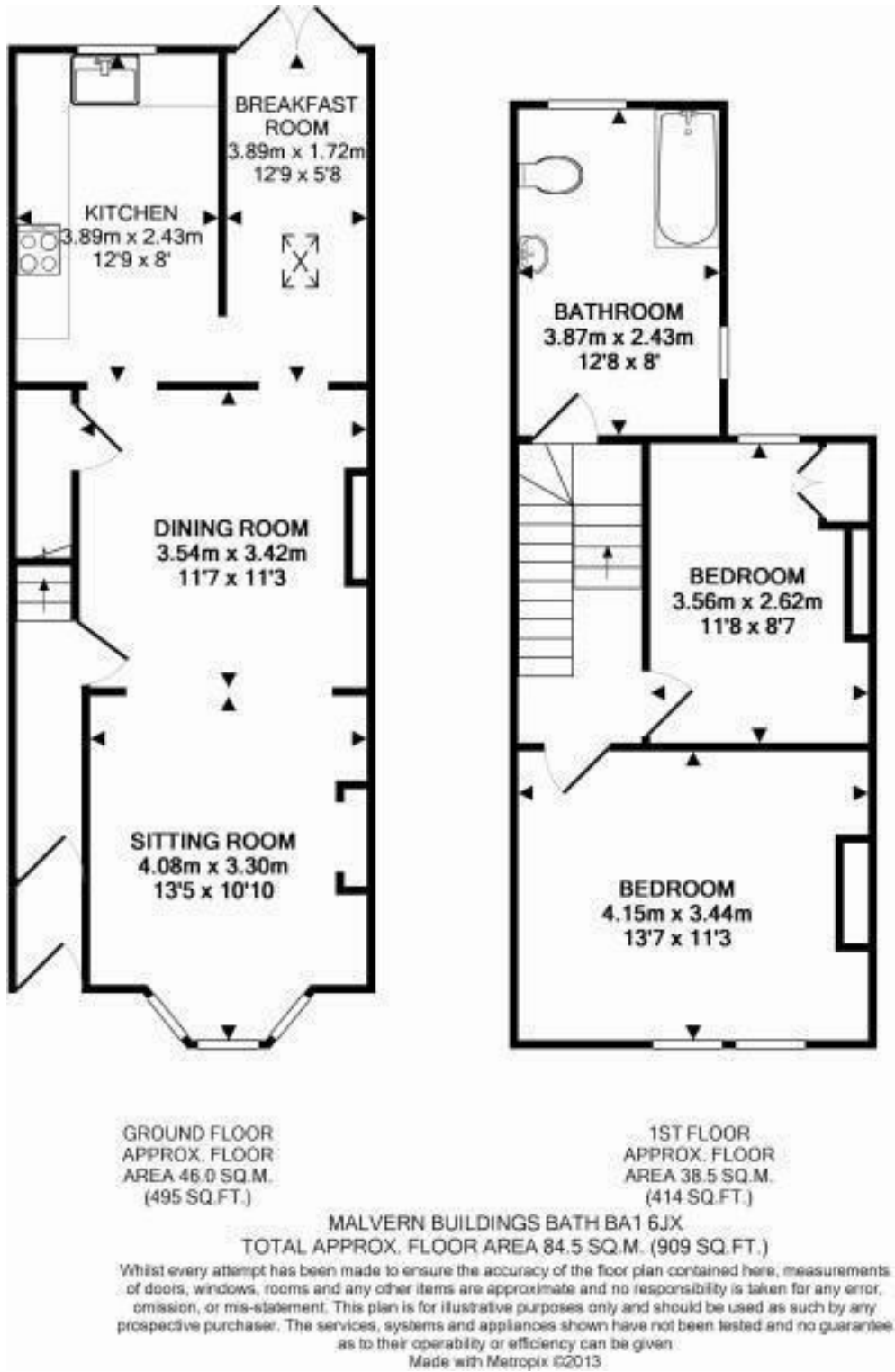

Energy Performance Graph

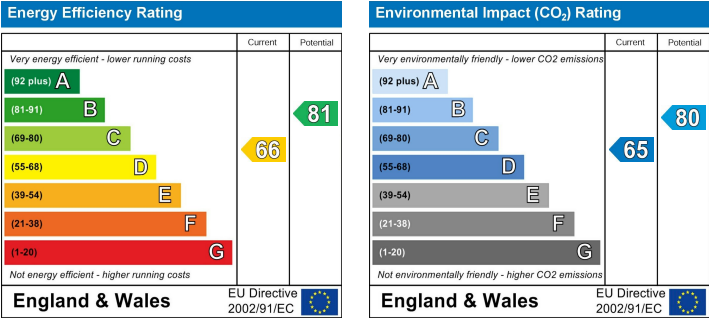

These particulars, whilst believed to be accurate are set out as a general outline only for guidance and do not constitute any part of an offer or contract. Intending purchasers should not rely on them as statements of representation of fact, but must satisfy themselves by inspection or otherwise as to their accuracy. No person in this firms employment has the authority to make or give any representation or warranty in respect of the property.